

AUTOMATIC DOUBLE SLIDING DOOR

SLD EI 30 | 60



FIRE RESISTANT INTERIOR DOORS (AUTOMATIC SLIDING DOOR)

INTERIOR APPLICATIONS

- > shopping malls
- > parkings
- > etc.

CLASSIFICATIONS

EI₁ 30 | 60

TYPES OF GLASS

- fire-resistant in combination with:
- > high efficiency glass and acoustic glass
 - > burglar- and bullet-resistant glass
 - > one-way mirror glass

KEYWORDS

- > access control system
- > maximum glazed
- > fire resistant on both sides
- > symmetric profile, with no visible glazing beads
- > high frequency

FINISHES

- > aluminium anodised or thermolac
- > steel thermolac
- > inox steel

CERTIFICATES



The **Meyvaert Classic** system is a framed construction with mullions and transoms. The modulation of the frame is based on the design of the architect. Within the technical range of the construction and its stability.

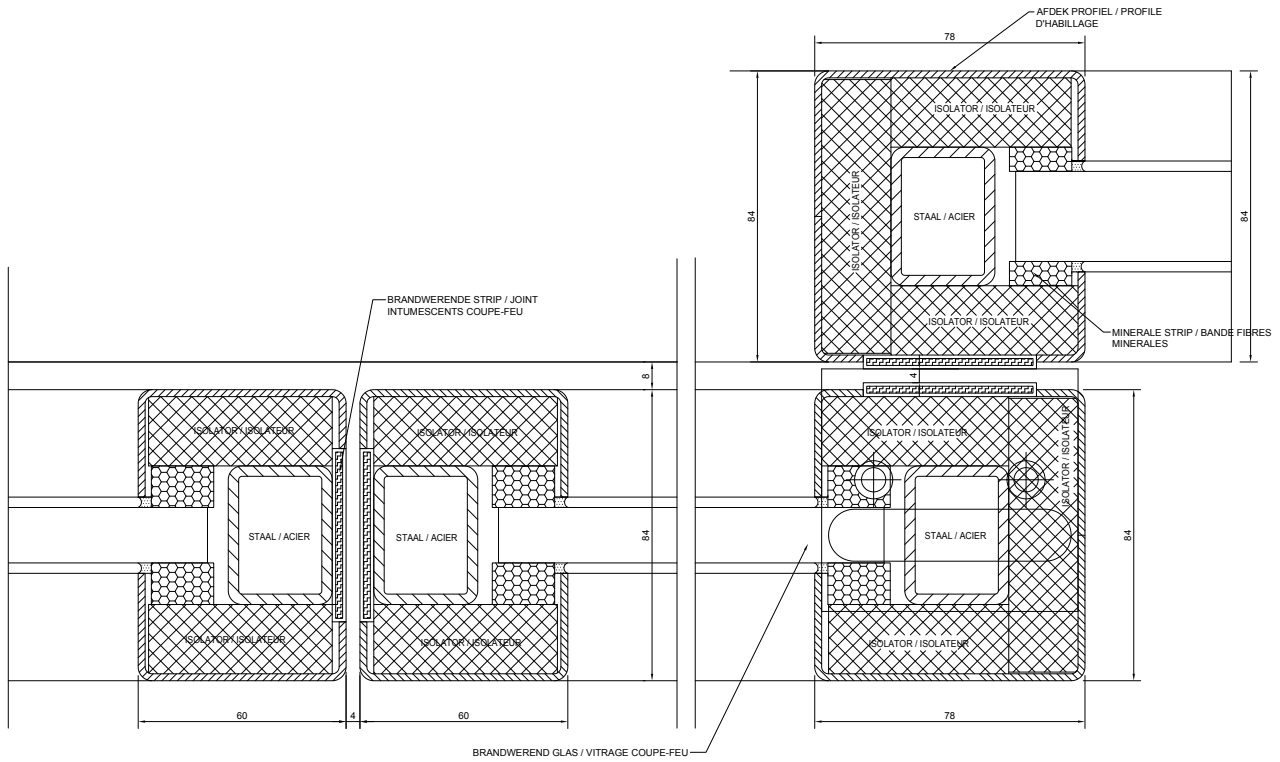

Non contractual document. All rights reserved MeyvaertGlass Engineering. - 2018

MEYVAERT CLASSIC AUTOMATIC DOUBLE SLD EI 30 | 60

ATTESTATIONS

- > european standard
EN 13501-2
- > technical approval

FIRE RESISTANCE

- E 30 | 60
- EW 30 | 60
- E₁ 30 | 60

SUPPORTS

- > drywall
- > concrete, cellular concrete and brick