

## PORTE DOUBLE

SWD EI **30 | 60**

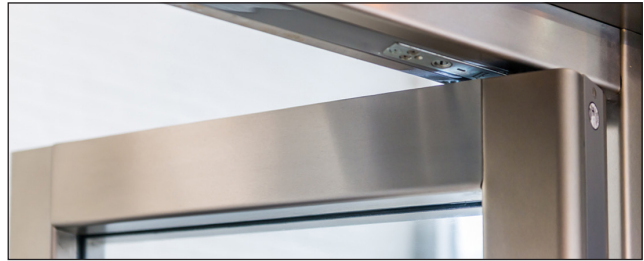

## FIRE RESISTANT INTERIOR DOORS (PIVOTING & ONE-WAY ROTATING)

### INTERIOR APPLICATIONS

- > stairwells
- > entrances
- > escape ways

### CLASSIFICATIONS

EI<sub>1</sub> 30 | 60

### TYPES OF GLASS

- fire-resistant in combination with:
- > high efficiency glass and acoustic glass
  - > burglar- and bullet-resistant glass
  - > one-way mirror glass

### KEYWORDS

- > tested for large dimensions
- > access control system
- > maximum glazed
- > fire resistant on both sides
- > symmetric profile, with no visible glazing beads
- > wide range of door handles and door knobs
- > independent door leafs

### FINISHES

- > aluminium anodised or thermolac
- > steel thermolac
- > inox steel

### CERTIFICATES



(NF : sur demande)

The **Meyvaert Classic** system is a framed construction with mullions and transoms. The modulation of the frame is based on the design of the architect. Within the technical range of the construction and its stability.

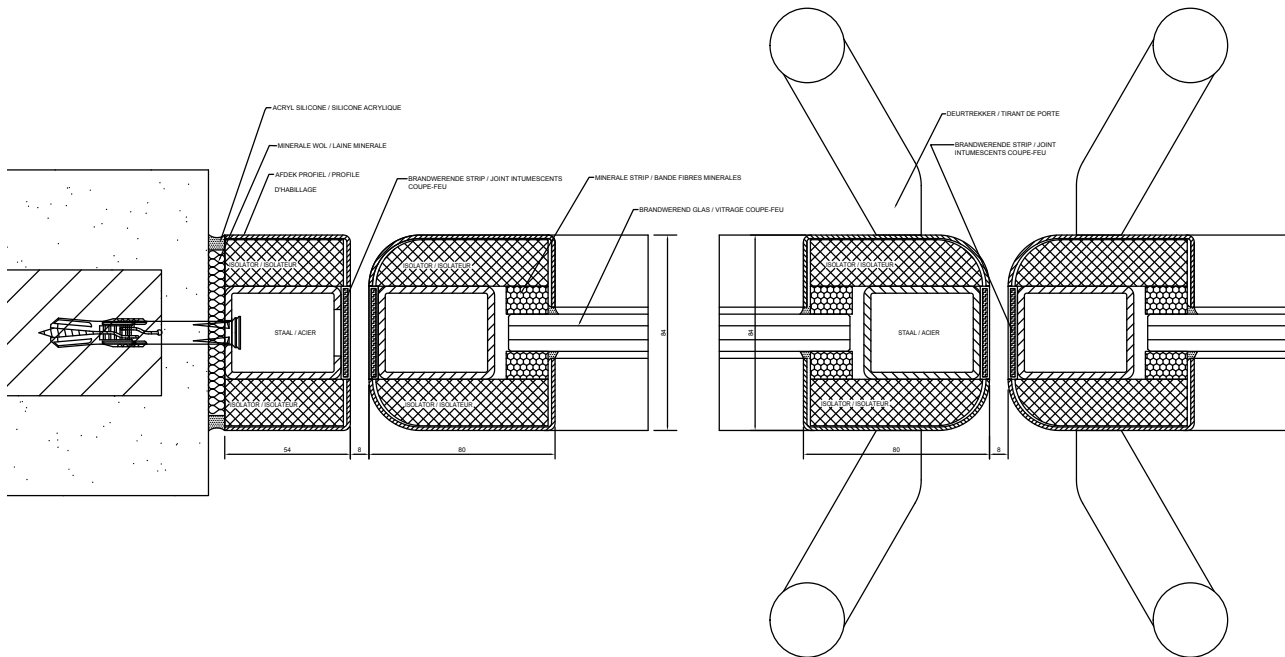

Non contractual document. All rights reserved MeyvaertGlass Engineering. - 2018

## MEYVAERT CLASSIC DOUBLE SWD EI 30 | 60

### ATTESTATIONS

- > european standard  
EN 13501-2 +A1 & EN 1364-1
- > technical approval

### FIRE RESISTANCE

- E 30 | 60
- EW 30 | 60
- EI<sub>1</sub> 30 | 60

### SUPPORTS

- > drywall
- > concrete, cellular concrete and brick